

1 **BEFORE THE ARIZONA POWER PLANT**
2 **AND TRANSMISSION LINE SITING COMMITTEE**

3 IN THE MATTER OF THE APPLICATION
4 OF CG APACHE COUNTY WIND LLC
5 AND CG APACHE COUNTY SOLAR LLC,
6 IN CONFORMANCE WITH THE
7 REQUIREMENTS OF ARIZONA
8 REVISED STATUTES §§ 40-360, ET SEQ.,
9 FOR A CERTIFICATE OF
10 ENVIRONMENTAL COMPATIBILITY
11 AUTHORIZING THE CONSTRUCTION
12 OF THE LAVA RUN
13 INTERCONNECTION PROJECT, A 345-
14 KILOVOLT (KV) ALTERNATING
15 CURRENT GENERATION TIE
16 TRANSMISSION LINE, WITH
17 ASSOCIATED INTERCONNECTION
18 FACILITIES, WITHIN APACHE
19 COUNTY, ARIZONA.

DOCKET NO.:

Case No.

20 **NOTICE OF HEARING**

21 **A PUBLIC HEARING WILL BE HELD** before the Arizona Power Plant and
22 Transmission Line Siting Committee (Committee) regarding the Application of CG
23 Apache County Wind LLC and CG Apache County Solar LLC (Applicants) for a
24 Certificate of Environmental Compatibility (CEC) authorizing the construction of the
25 Lava Run Interconnection Project (Project), a 345-kilovolt (kV) alternating current
26 generation tie transmission line (Application).

27 The purpose of the Interconnection Project is to connect the Lava Run Wind
28 Project, a proposed 500 megawatt (MW) wind facility (Wind Facility) and the Lava Run
29 Solar Project, a proposed 450 MW solar facility (Solar Facility) with an on-site 450 MW
30 battery energy storage system (BESS), to the Springerville Substation. A map of the
31 Project is attached as **Exhibit A**.

32 A hearing on the Application will be held at Hon-Dah Resort Casino, 777 Highway
33 260, Pinetop, AZ 85935. **The hearing will begin on Monday, October 20, 2025, at 1:00**
34 **p.m. and will continue as necessary through Friday, October 24, 2025, commencing**

1 at 9:00 a.m. each day at the same location as necessary through the completion of the
2 hearing. If any revisions to the hearing schedule are required, they will be noticed on the
3 Project website at: <https://www.lavarunprojects.com/> and on the Arizona Corporation
4 Commission (ACC or Commission) website at: [https://www.azcc.gov/arizona-power-](https://www.azcc.gov/arizona-power-plant/hearings-and-meetings)
5 [plant/hearings-and-meetings](https://www.azcc.gov/arizona-power-plant/hearings-and-meetings).

6 PUBLIC COMMENT WILL BE TAKEN IN A SPECIAL EVENING
7 SESSION ON OCTOBER 20, 2025, AT 5:30 P.M., VIA TELEPHONE, ZOOM, OR
8 IN PERSON AT HON-DAH RESORT CASINO, 777 HIGHWAY 260, PINETOP,
9 ARIZONA 85935. PUBLIC COMMENT MAY ALSO BE TAKEN AT THE
10 BEGINNING OF EACH HEARING DAY, OR, AT OTHER TIMES DURING THE
11 HEARING AT THE DISCRETION OF THE COMMITTEE CHAIRMAN.

12 PLEASE BE ADVISED THAT ALL LOCAL AND STATE PUBLIC
13 HEALTH AND SAFETY GUIDELINES WILL BE FOLLOWED DURING THE
14 HEARING AND PUBLIC COMMENT SESSION. RESTRICTIONS ON PUBLIC
15 ACCESS, SAFETY PROTOCOLS, AND REVISIONS TO THE HEARING
16 SCHEDULE MAY OCCUR DUE TO PUBLIC HEALTH CONSIDERATIONS.

17 THE PUBLIC HAS THE OPTION TO WATCH THE HEARING ONLINE
18 OR LISTEN TO THE HEARING VIA TELEPHONE. At least 24 hours in advance of
19 the hearing, information regarding online and telephone hearing access, as well as any
20 additional details regarding safety protocols or other revisions to the hearing schedule will
21 be posted on the Applicant's Project website at: <https://www.lavarunprojects.com/>.

22 The Chairman may, at his discretion, recess the hearing to a time and place to be
23 announced during the hearing, or to be determined after the recess. The date, time and
24 place at which the hearing will be resumed will be posted on the above-noted Project
25 website and the ACC website. NOTE: NOTICE OF ANY SUCH RESUMED
26 HEARING WILL BE GIVEN; HOWEVER, PUBLISHED NOTICE OF SUCH A
27 RESUMED HEARING IS NOT REQUIRED.

1 If the Committee decides to conduct a tour of the Project, notice that includes a
2 map and itinerary of any such tour will be available at the hearing and posted on the Project
3 and Commission websites. Members of the public may follow the Committee on the tour.
4 During the tour, the Committee may hear testimony at stops on the tour concerning what
5 is visible at stops and the relevance of the location and view to the Project. No other
6 discussion or deliberation concerning the Application will occur during the tour. A court
7 reporter or recording device will record any testimony taken on the tour for transcription.
8 Public health and safety protocols specific for the tour will be included on the itinerary.
9 If the Committee decides not to take a tour, the hearing will continue as scheduled.

10 A map of the Project site and detailed information about the Project are contained
11 in the Application, which is available for inspection at the following locations:

- 12 • Commission Docket Control Center, Phoenix Office, 1200 West Washington
13 Street, Suite 108, Phoenix, AZ 85007
- 14 • Round Valley Public Library, 179 South Main Street, Eagar, AZ 85925
- 15 • St. Johns Public Library, 35 South 3rd West, St. Johns, AZ 85936
- 16 • Project Website: <https://www.lavarunprojects.com/>

17 The Applicant will make available final copies of the pre-filing conference, pre-
18 hearing conference and hearing transcripts at each of the above locations and website.

19 Each county, municipal government, and state agency interested in the Project that
20 desires to be a party to the proceedings shall, not less than ten (10) days before the date
21 set for the hearing, file a Notice of Intent to Become a Party with the Director of Utilities,
22 Commission, 1200 West Washington Street, Phoenix, AZ 85007.

23 Any domestic non-profit corporation or association formed in whole or in part to
24 promote conservation or natural beauty, to protect the environment, personal health or
25 other biological values to preserve historical sites, to promote consumer interests, to
26 represent commercial and industrial groups, or to promote the orderly development of the
27 area in which the Project is located that desires to become a party to the proceedings shall,
28

1 not less than ten (10) days before the date set for the hearing, file a Notice of Intent to
2 Become a Party with the Director of Utilities, Commission, 1200 West Washington Street,
3 Phoenix, AZ 85007.

4 The Committee or the Chairman, at any time deemed appropriate, may make other
5 persons parties to the proceedings. Any person may make a limited appearance at a hearing
6 by filing a statement in writing with the Director of Utilities, Commission, 1200 West
7 Washington Street, Phoenix, AZ 85007, and the Chairman of the Committee at 2005 North
8 Central Avenue, Phoenix, AZ 85007, not less than five (5) days before the date set for the
9 hearing. A person making a limited appearance will not be a party or have the right to
10 present testimony or cross-examine witnesses.

11 This proceeding is governed by Arizona Revised Statutes (A.R.S.) §§ 40-360 to
12 40-360.13 and Arizona Administrative Code Rules (A.A.C.) R14-3-201 to R14-3-220. No
13 substantive communication, not in the public record, may be made to any member of the
14 Committee. The written decision of the Committee will be submitted to the Commission
15 pursuant to A.R.S. § 40-360.07. Any person intending to be a party to the proceeding on
16 the matter before the Commission must be a party to the proceeding before the Committee.

17
18 ORDERED this _____ day of September, 2025.

19
20
21 _____
22 Adam Stafford, Chairman
23 Arizona Power Plant and Transmission Line
24 Siting Committee
25 Assistant Attorney General
26
27
28

1 **CERTIFICATE OF MAILING**

2
3 **ORIGINAL** of the foregoing e-filed
4 this _____ day of September, 2025, with

5 Utilities Division-Docket Control
6 ARIZONA CORPORATION COMMISSION
7 1200 West Washington Street
8 Phoenix, AZ 85007

9 **COPY** of the foregoing e-mailed
10 this _____ day of September, 2025, to:

11 Legal Division
12 ARIZONA CORPORATION COMMISSION
13 1200 W. Washington Street
14 Phoenix, AZ 85007
15 legaldiv@azcc.gov

16 Utilities Division
17 ARIZONA CORPORATION COMMISSION
18 1200 West Washington Street
19 Phoenix, AZ 85007
20 utildivservicebyemail@azcc.gov

21 Glennie Reporting Services, LLC
22 1555 East Orangewood
23 Phoenix, AZ 85020
24 admin@glennie-reporting.com

25 J. Matthew Derstine
26 Snell & Wilmer, L.L.P.
27 One East Washington Street
28 Suite 2700
Phoenix, AZ 85004
mderstine@swlaw.com
Counsel for Applicant CG Apache County Wind LLC
and CG Apache County Solar LLC

Apache County
Ryan Patterson, Manager

1 75 West Cleveland,
2 St. Johns, AZ 85936

3 Town Of Eagar
4 Brannon Eagar, Town Manager
5 22 W. 2nd St. PO Box 1300
6 Eagar, AZ 85925

7 Town of Springerville
8 Tim Rasmussen, Town Manager
9 418 E Main Street,
10 Springerville, AZ 85938

11 Arizona Department of Transportation
12 Priscilla Thompson, Assistant District Engineer, South Central District
13 1221 S. Second Avenue
14 Tucson, AZ 85713

15 Arizona Department of Transportation
16 Nicholas Edwards, PE
17 North/South Project Manager - MPD
18 1611 W. Jackson
19 MD310B
20 Phoenix, AZ 85007

21 Arizona State Land Department
22 Ruben Ojeda, Assistant Director
23 Real Estate Division
24 1110 W. Washington Street,
25 Phoenix, AZ 85007

26 By: _____
27
28

1
2
3
4
5
6
7
8
9
10
11
12
13
14
15
16
17
18
19
20
21
22
23
24
25
26
27
28

EXHIBIT A

**LAVA RUN INTERCONNECTION
PROJECT**

CEC Features

- Requested CEC
- Corridor

Interconnection Project

Reference Features

- Tucson Electric Power
(TEP) Springerville
Generating Station
- Railways
- Highways
- Roads
- Little Colorado River

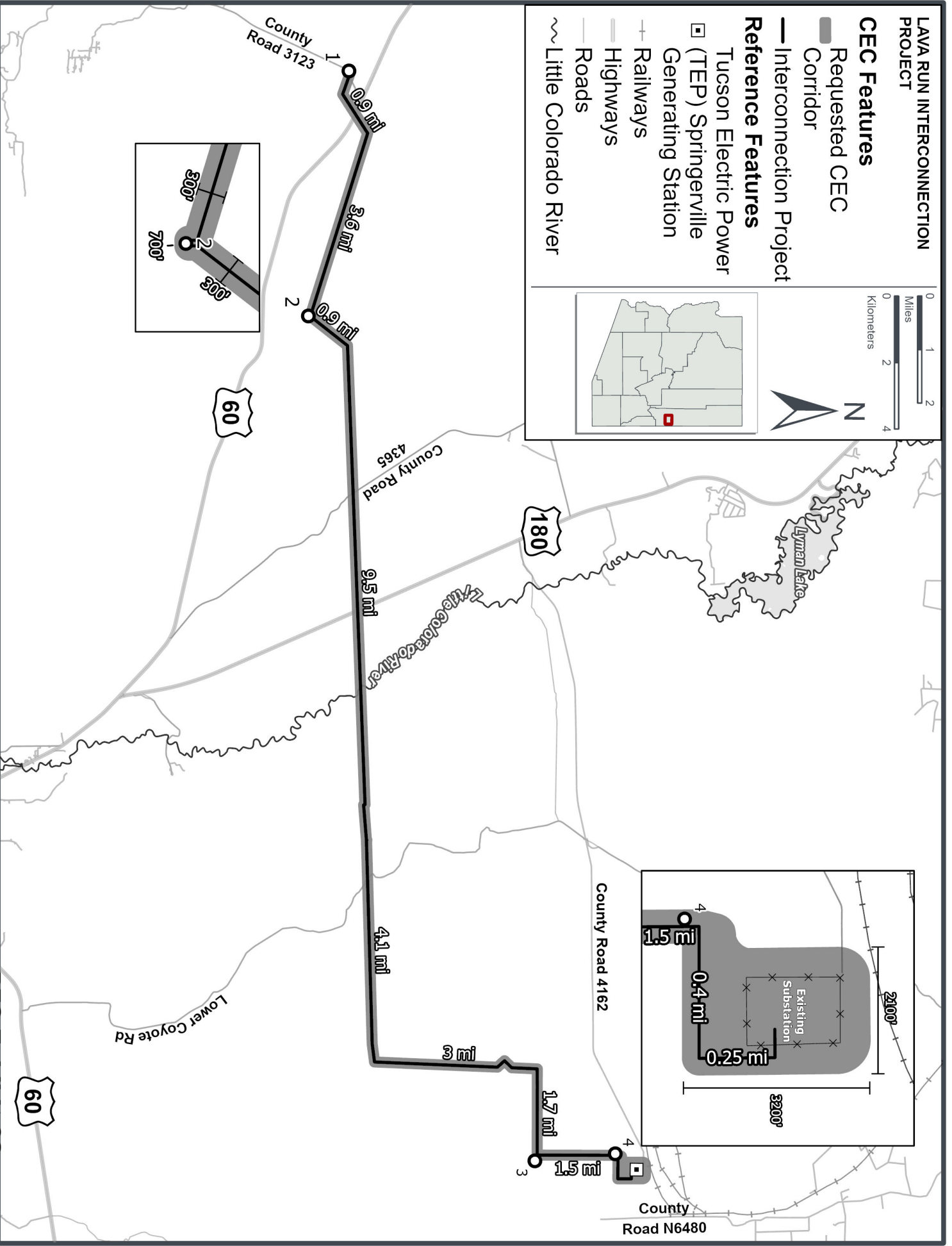
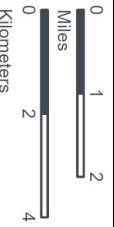

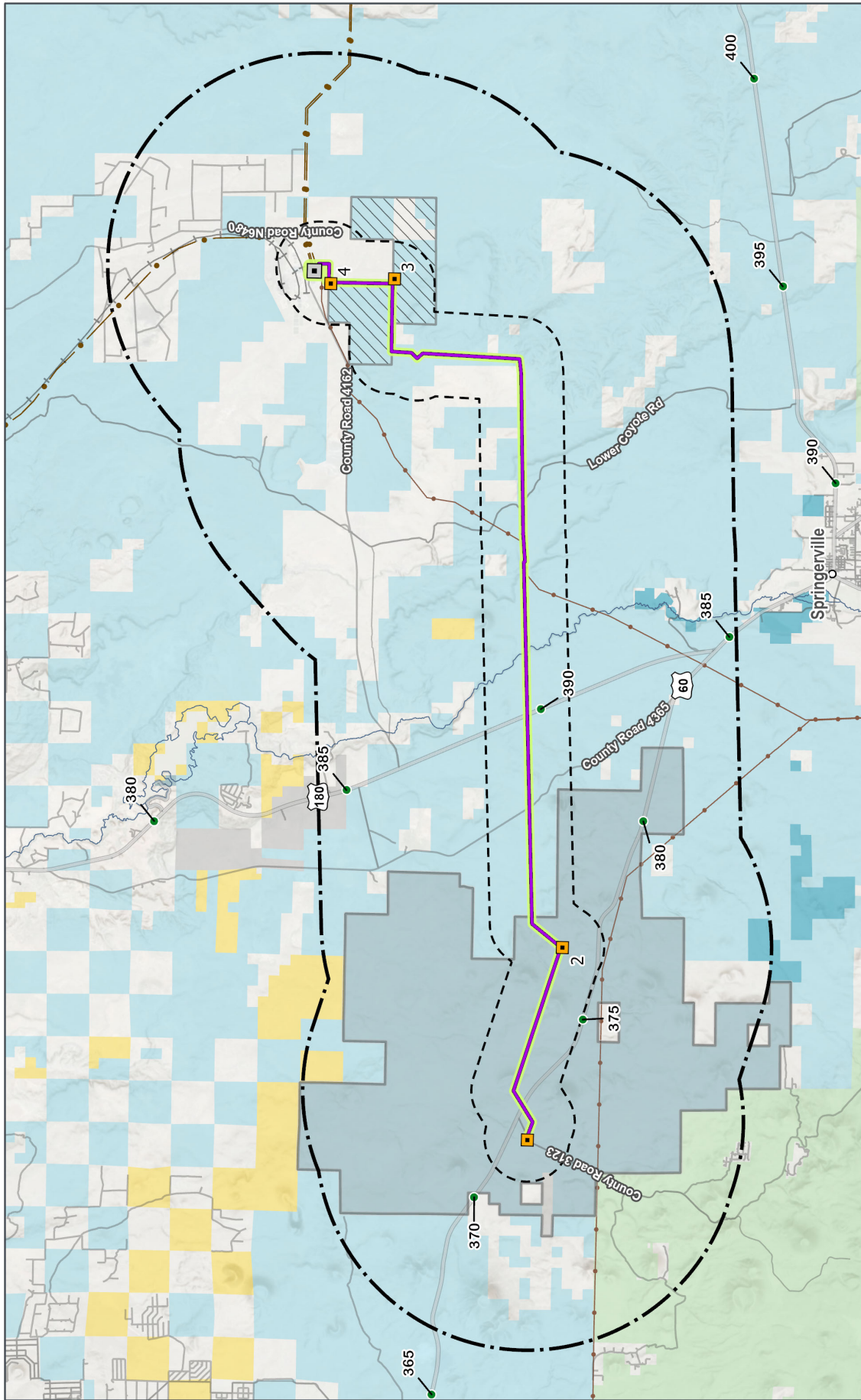

Apache County, AZ
 USGS 7.5' Quadrangle:
 Lyman Lake, AZ, 34109-C3
 Voigt Ranch, AZ, 34109-C2
 Whiting Knoll, AZ, 34109-B5
 Springerville NW, AZ, 34109-B4
 Springerville, AZ, 34109-B3
 Coyote Hills, AZ, 34109-B2
 NAD 1983 UTM Zone 12N
 34,269°N 109,3396°W

Base Map: Esri ArcGIS Online,
 accessed August 2025
 Updated: 8/28/2025
 Project No: 64296
 Layout: Public Notice
 Aprx: 64296_LavaRunCEC

0 2 4 Miles
 0 2 4 Kilometers
 N
 1:200,000

SWCA
 ENVIRONMENTAL CONSULTANTS

Reference Features
 Project Substations
 Lava Run Wind Project Area
 Lava Run Solar Project Area
 Tucson Electric Power (TEP) Springerville Generating Station

Existing Infrastructure
 Existing 69-kV Transmission Line
 Existing 345-kV Transmission Line
 Highways
 Roads
 Railways
 Milepost Markers (5-mile Interval)

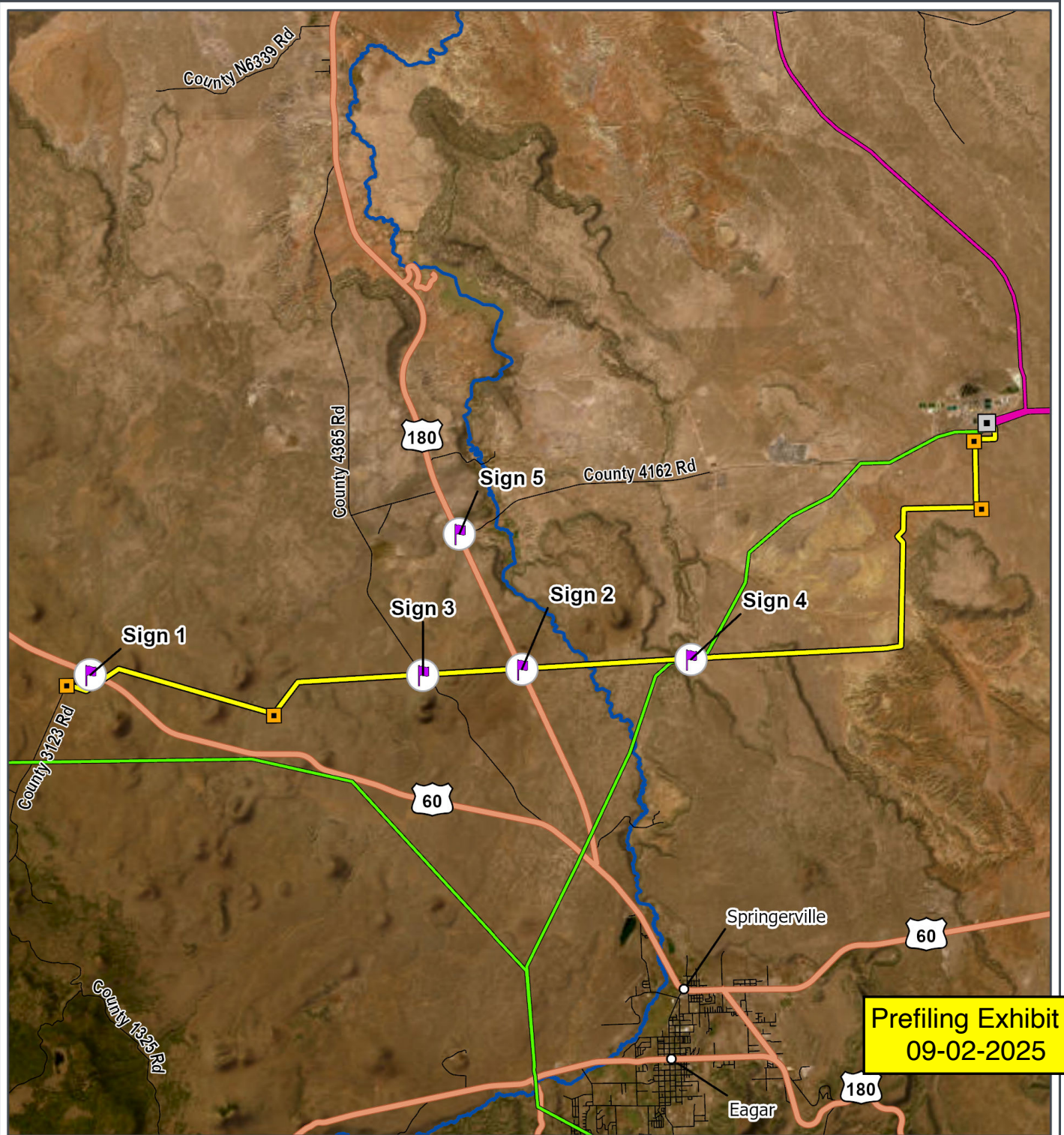

Land Ownership
 Bureau of Land Management
 County
 Local or State Parks
 Private
 State Trust
 State Wildlife Area
 US Forest Service

Public Notification
 Boundary
 Study Area 1-mile
 Interconnection Project
 Requested CEC Corridor



**LAVA RUN
INTER-
CONNECTION
PROJECT**



CEC Features

-  Generation Tie Line
-  Proposed Sign Locations

Reference Features

-  Project Substations
-  Tucson Electric Power (TEP)
-  Springerville Generating Station
-  Little Colorado River
-  U.S. Highway
-  Roads

Transmission Lines

-  69kV Transmission Line
-  345kV Transmission Line

Apache County, AZ
USGS 7.5' Quadrangle:
Lyman Lake, AZ, 34109-C3
Voigt Ranch, AZ, 34109-C2
Whiting Knoll, AZ, 34109-B5
Springerville NW, AZ, 34109-B4
Springerville, AZ, 34109-B3
Coyote Hills, AZ, 34109-B2
NAD 1983 UTM Zone 12N
34.2687°N 109.3403°W

Base Map: ESRI ArcGIS Online,
accessed August 2025
Updated: 8/19/2025
Project No. 77230
Layout: Proposed Sign Map
Aprx: 64296_LavaRunCEC

